



LIST OF BEDROOMS & FLOOR PLANS AT WINSHAM MANOR

BEDROOMS – sleeps 16-22 in 8 bedrooms

● indicates a choice of bed configuration

Bedroom	Beds	Sleeps	Features
1. Northumberland (Ground floor)	Four-poster queen size bed	2	Four-poster bedroom with even access on parquet flooring. En-suite shower room with Mandarin Stone marble walls / flooring, underfloor heating.
2. The Dollard Hulke (First floor)	Super king size bed (can be divided into two single beds) ● plus optional extra bateau bed	2 + 1 child	20s style double-aspect (south/west) corner room with lovely views over croquet lawn and garden. En-suite Mandarin Stone marble bathroom with bathtub and shower over.
3. The Oak Room (First floor, garden facing)	King size bed with coronet plus extra single French mahogany bed	2 + 1 adult/ child	Beautiful oak panelling with south-facing bay window, full view over the croquet lawn. Large rain-shower en-suite Mandarin Stone marble bathroom.
4. The Charleston (First floor, off the Great Chamber)	King size mahogany sleigh bed, plus single mahogany bateau bed	2 + 1 child	Charming bedroom above the dining room overlooking the courtyard & parkland (beautiful sunrises). En-suite Mandarin Stone marble shower room.
5. The Sanctuary (Second floor, above The Charleston)	King size mahogany sleigh bed, plus two single guest beds	2 + 2 adults/ children	Tucked away bedroom with its own little staircase and adjacent Mandarin Stone marble shower room at base of staircase. The shower room is small, but the family bathroom is also close by.
6. The Wattle Room (Second floor, south-east side)	Super king size bed (can be divided into two single beds) ● plus single day bed	2 + 1 adult/ child	Triple aspect room (east/south), views of courtyard, landscape, valley and gardens. En-suite Emperador dark maroon marble shower room.



Bedroom	Beds	Sleeps	Features
7 and 8. The Henley Suite (Second floor, south facing)	Super king four-poster bed (in own room) plus double sleigh bed in anteroom	2 + 2 adults/ children	Magnificent four-poster bed with silk pleated ceiling and drapes, beautiful south-facing views from both rooms overlooking croquet lawn, landscapes. Mandarin Stone marble bathroom with bath and shower over.
Total		16-22	

There is an additional bathroom on the ground floor with bath and handheld shower. Plus, on the first floor there's an additional family bathroom with free-standing oval stone resin bathtub and large walk-in rain shower, ideal for those seeking quiet relaxation.

FLOOR PLANS – ground floor

GROUND FLOOR



GROSS INTERNAL AREA
FLOOR 1: 290 m², FLOOR 2: 292 m²
FLOOR 3: 115 m²
TOTAL: 697 m²
SIZES AND DIMENSIONS ARE APPROXIMATE. ACTUAL MAY VARY.



BIG HOUSE EXPERIENCE

FLOOR PLANS – first floor

FIRST FLOOR



GROSS INTERNAL AREA
FLOOR 1: 290 m², FLOOR 2: 292 m²
FLOOR 3: 115 m²
TOTAL: 697 m²

SIZES AND DIMENSIONS ARE APPROXIMATE, ACTUAL MAY VARY.



BIG HOUSE EXPERIENCE

FLOOR PLANS – second floor

SECOND FLOOR:

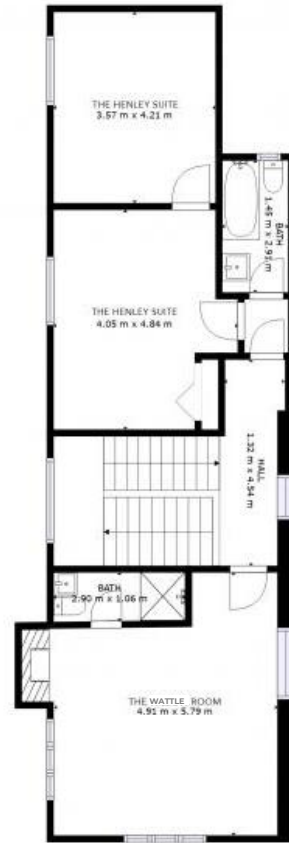

GROSS INTERNAL AREA
FLOOR 1: 290 m², FLOOR 2: 292 m²
FLOOR 3: 115 m²
TOTAL: 697 m²
SIZES AND DIMENSIONS ARE APPROXIMATE, ACTUAL MAY VARY.



BIG HOUSE EXPERIENCE