



LIST OF BEDROOMS & FLOOR PLANS AT BELWICK HALL

BEDROOMS – sleeps 16 (+1*) in 8 bedrooms

● indicates a choice of bed configuration

Bedroom	Beds	Sleeps	Features
Master Bedroom (first floor)	Super king size bed	2 (+1*)	Private ensuite bathroom with bath and shower head. Dressing room* (can be used as a bedroom with a day bed – it has its own doorway to the hall).
Bedroom 1 Green & Pink (first floor)	Super king size bed (can be divided into two single beds) ●	2	Private ensuite bathroom with bath and shower head.
Bedroom 2 Rose Room (first floor)	King size bed	2	Private bathroom with bath and shower head.
Bedroom 3 Grey Stripe (first floor)	Super king size bed (can be divided into two single beds) ●	2	Private bathroom with bath and shower head.
Bedroom 4 Scandi Room (second floor)	Double bed	2	Shared shower room. Access to second floor shower room is via bedroom 5. Alternatively, there is a shared shower room on the first floor, at the bottom of the stairs by the bedroom (see floor plans).
Bedroom 5 Hummingbird (second floor)	Super king size bed (can be divided into two single beds) ●	2	Shared shower room on second floor.
Bedroom 6 Blue Trellis (second floor)	Super king size bed (can be divided into two single beds) ●	2	Shared shower room on second floor.
Bedroom 7 Yellow Room (second floor)	Super king size bed (can be divided into two single beds) ●	2	Shared shower room on second floor.
Total		16 (+1*)	

All bedrooms are large enough to accommodate a cot.

There is an additional shared family shower room on the first floor.



FLOOR PLANS – ground floor

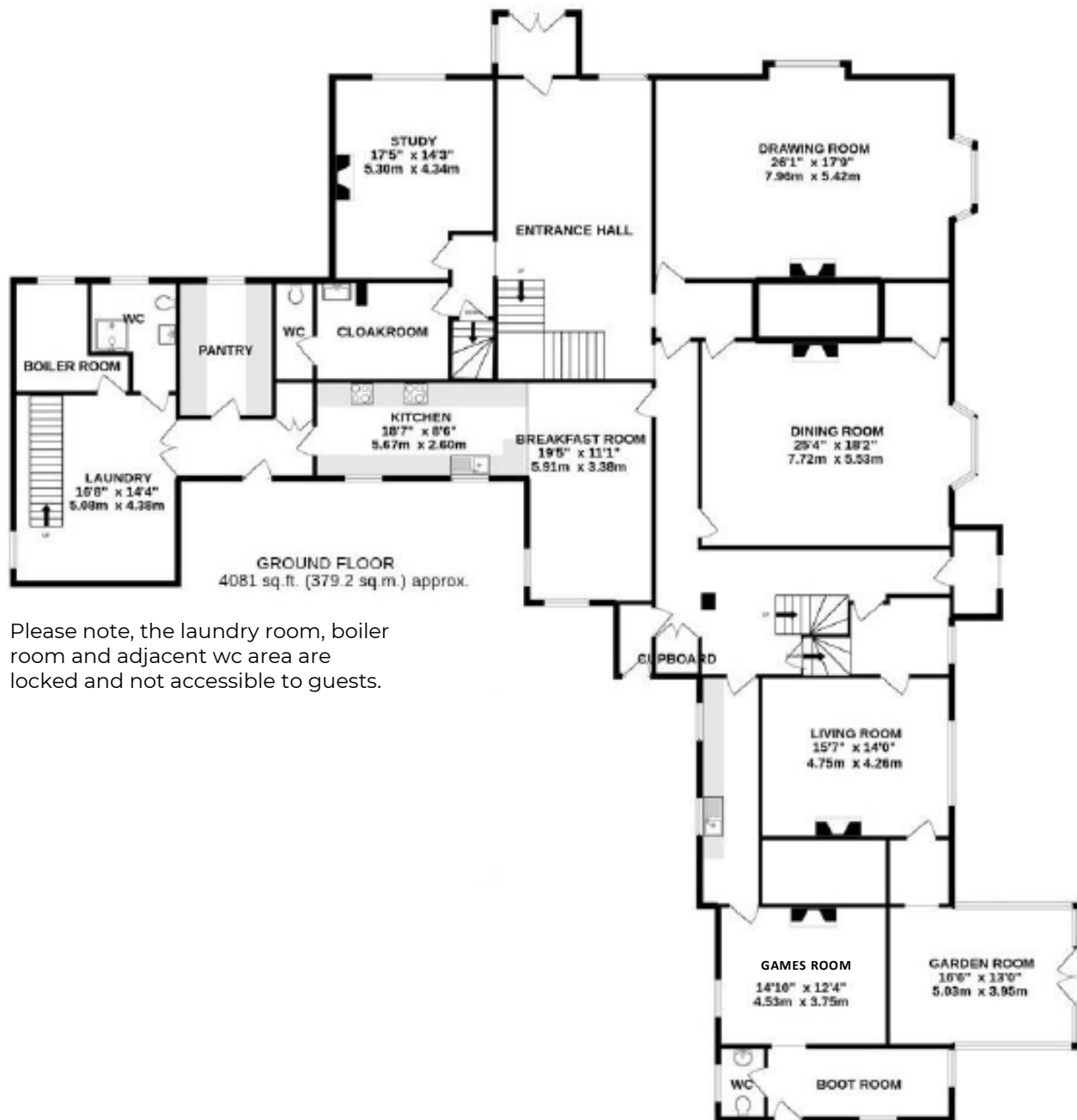

Please note, the laundry room, boiler room and adjacent wc area are locked and not accessible to guests.



FLOOR PLANS – first floor

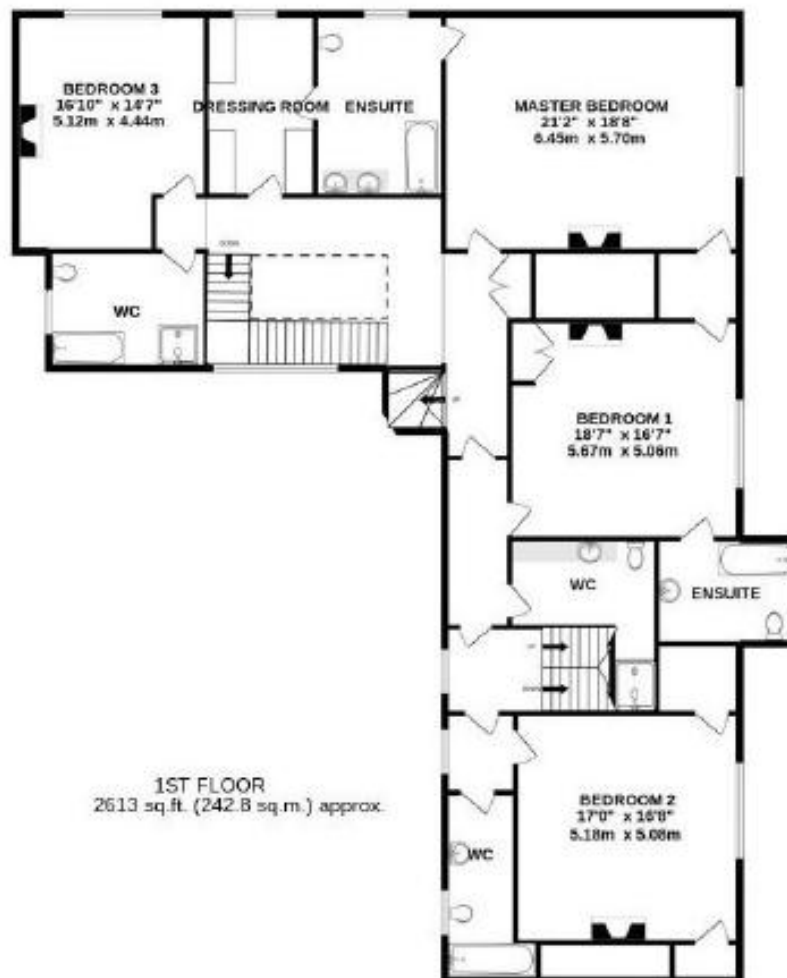

FLOOR PLANS – second floor

