



## LIST OF BEDROOMS & FLOOR PLANS AT CROMARTY HOUSE

### BEDROOMS – sleeps 22 in 11 bedrooms

● indicates a choice of bed configuration

Bedroom	Beds	Sleeps	Features
Cairngorm (First floor - Suite)	Super king size bed	2	Interconnecting room with Tomatin. Ensuite with bath and separate shower.
Glenlivet (First floor - Executive)	Super king size bed	2	Ensuite with bath and separate shower.
Abercrombie (First floor - Executive)	Super king size bed (can be divided into two single beds) ●	2	Ensuite with bath with shower over.
Benromach (First floor - Executive)	Super king size bed	2	Ensuite with bath with shower over.
Glenbogle (First floor - Superior)	Super king size bed	2	Ensuite shower room.
Glenfiddich (First floor - Superior)	Super king size bed	2	Ensuite with bath with shower over.
Aviemore (First floor - Superior)	Super king size bed (can be divided into two single beds) ●	2	Ensuite with bath with shower over.
Tomatin (First floor - Classic)	Super king size bed (can be divided into two single beds) ●	2	Interconnecting room with Cairngorm. Ensuite shower room.
Abernethy (First floor - Classic)	Double bed	2	Ensuite shower room.
Dalwhinnie (Second floor - Classic)	Super king size bed (can be divided into two single beds) ●	2	Ensuite with bath and separate shower.
Speyside (Second floor - Superior)	Super king size bed	2	Ensuite with bath with shower over.
<b>Total</b>		<b>22</b>	



# FLOOR PLANS – ground floor

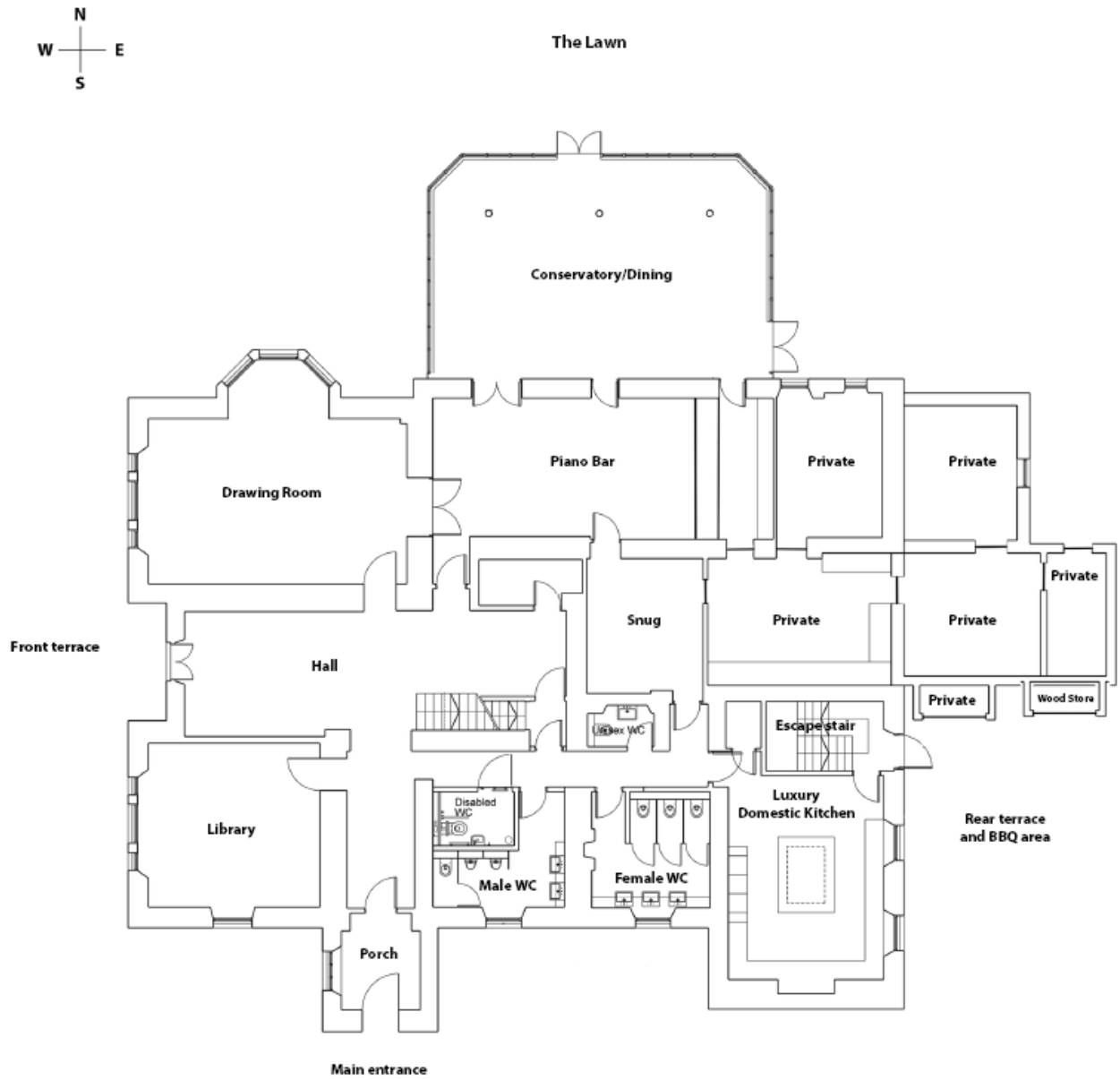

# FLOOR PLANS – first & second floors

